

ConnectStation CS1-M MobileConnect

Quick Guide

1 Connecting the product to the mains

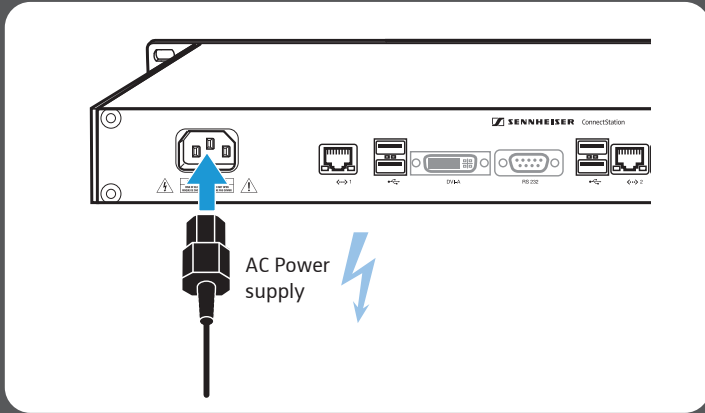

2 Connecting audio devices

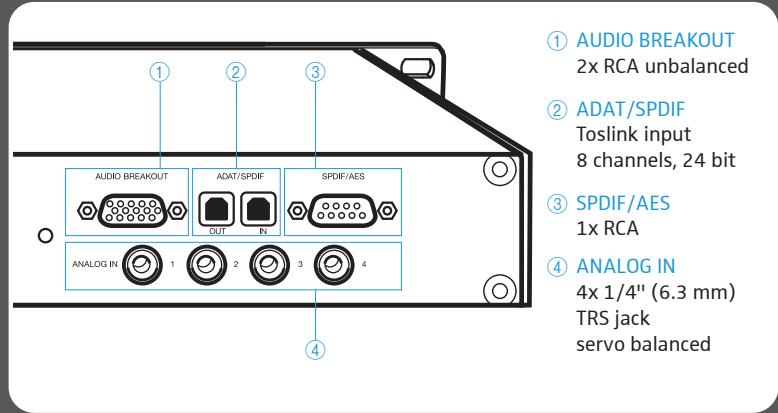

3 Switching the product ON

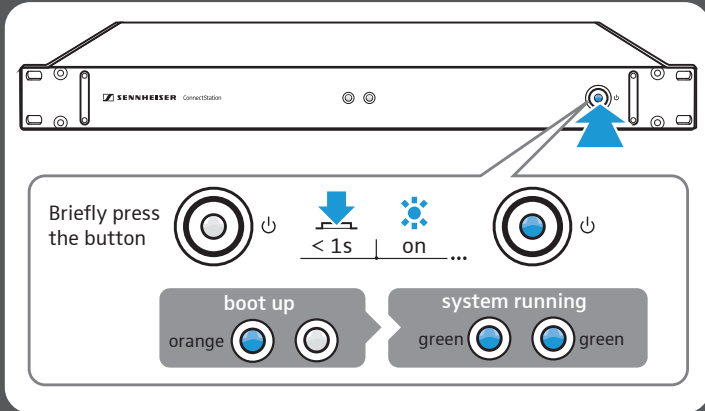

4 Connecting the access point

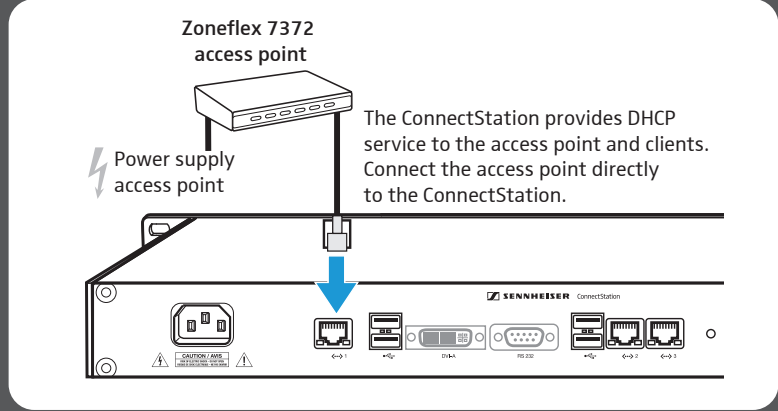

5.1 Connecting a laptop

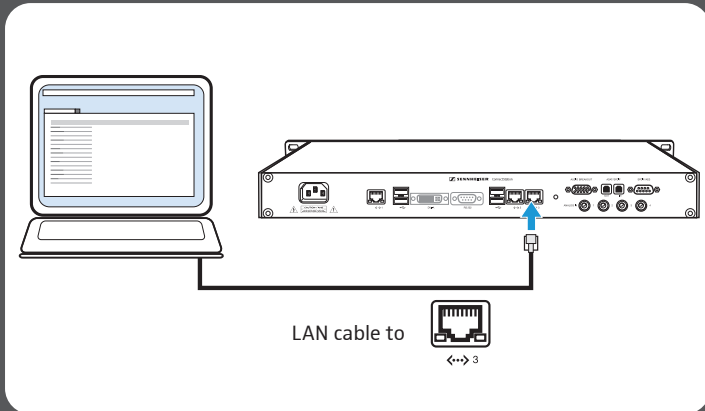

5.2 Configuring the laptop

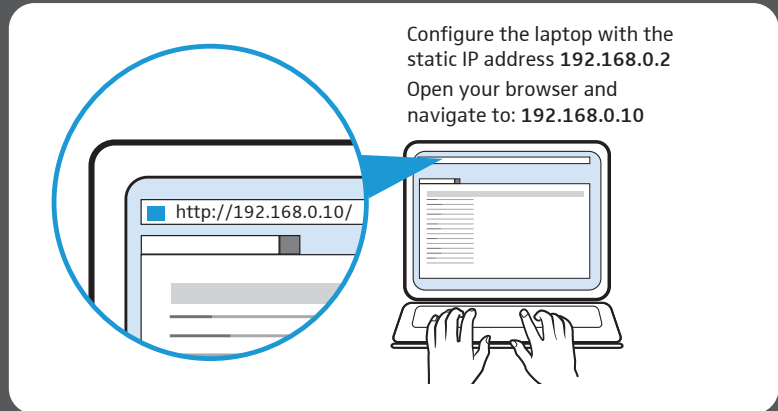

5.3 Logging in to the system

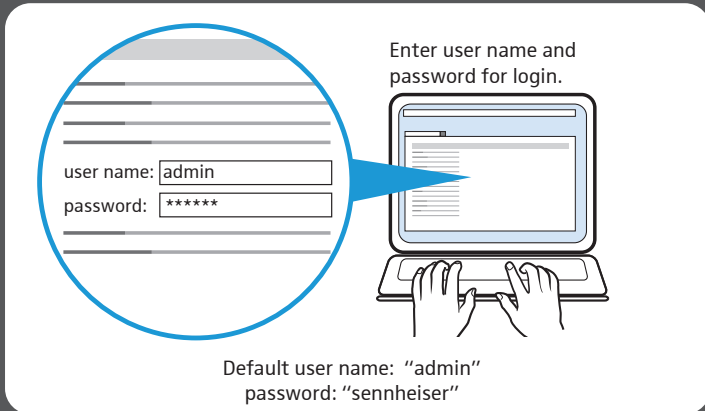

5.4 Performing the initial setup

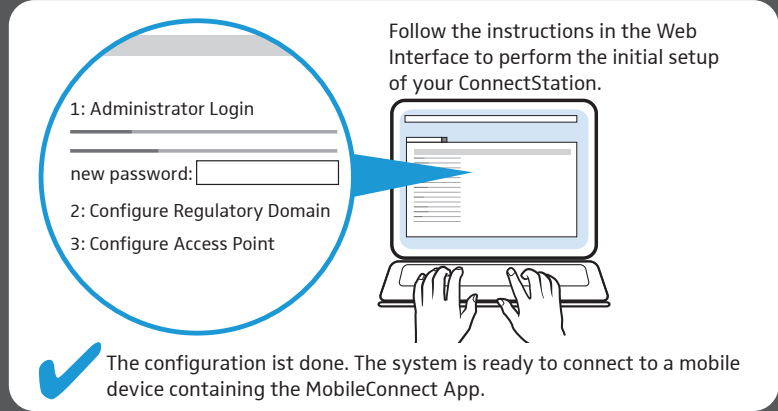

ConnectStation CS1-M MobileConnect

Specifications

Dimensions W x D x H	48.3 cm x 24.0 cm x 4.4 cm (19.0" x 9.5" x 1.7")
Weight	2.9 kg (6.39 lbs)
Power supply	100 - 240 V AC, 50/60 Hz, max. 600 mA
Power	60 W nominal
Operating temperature	+5 °C to +45 °C (41°F to 113 °F)
Storage temperature	-20 °C to +75 °C (-4°F to 167 °F)
Operating humidity	10 % to 90 % @ 25 °C non-condensing
Storage humidity	5 % to 95 % @ 25 °C non-condensing
AUDIO BREAKOUT	
Input	2x RCA unbalanced
Input impedance	10 kΩ
Input sensitivity	Low gain, +4 dBu, -10 dBV
Resolution AD	24 bit
Frequency response AD	5 Hz to 21.5 kHz
@ 44.1 kHz, -0.5 dB	
ADAT/SPDIF	
Input	TOSLINK
Standard	8 channels, 24 bit, up to 48 kHz
Lock range	31.5 to 50 kHz
SPDIF/AES	
Input	1x RCA
SPDIF compatible	IEC 60958
Impedance	75 Ω
Lock range	27 to 200 kHz
ANALOG IN	
Input	4x 1/4" (6.3 mm) TRS jack, servo balanced
Input impedance	10 kΩ
Input sensitivity	Low gain, +4 dBu, -10 dBV
Resolution AD	24 bit
Frequency response AD	5 Hz to 21.5 kHz
@ 44.1 kHz, -0.5 dB	
Sample rate	48 kHz

 For more detailed specifications please refer to the product specification sheet in the download area of the product page at www.sennheiser-connect.com.

6 Switching the product OFF

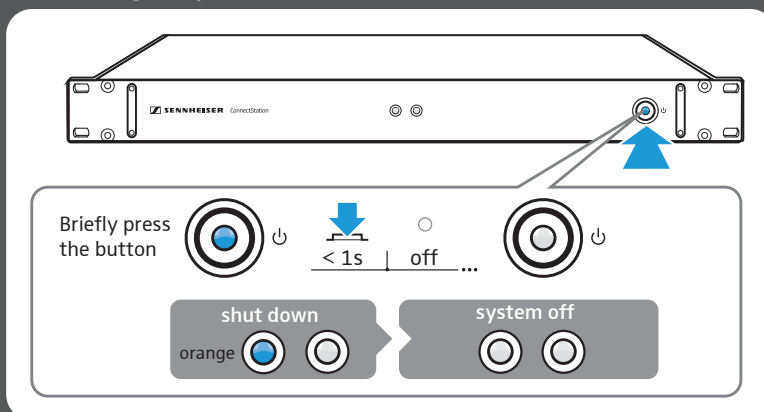

Delivery includes

- 1x ConnectStation CS1-M
- 1x Power Supply Cable 1.8 m (EU/UK/US)
- 1x Ruckus ZoneFlex 7372 Access Point (worldwide/US)
- 1x Ruckus Power Supply Adapter for Access Point (EU/UK/US)
INPUT: 100 – 240 V AC, 50/60 Hz, 0.4 A
OUTPUT: 12 V DC, 1.0 A

Audio Cables

- 1x 15-pin D-sub to 4 x RCA Analog, 2 x MIDI, 1 x Phones
- 1x 9-pin D-sub to 2 x RCA Digital (SPDIF)
- 1x Toslink Cable 2 mm, 2m

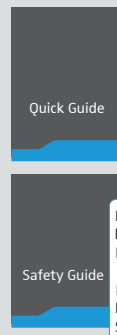

Specifications

List of Audio Channels

Analog In 4 Channels	Active
SPDIF	Active
Analog I/O 2 Channels	Active
ADAT Input	Active
ADAT Output	N.A.

Checking for errors – Troubleshooting

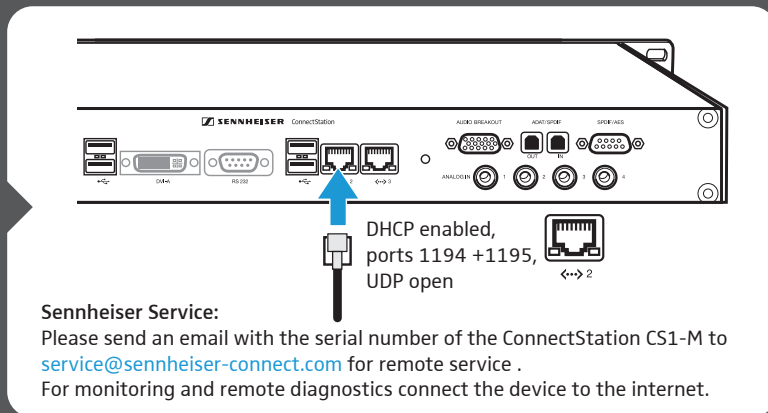
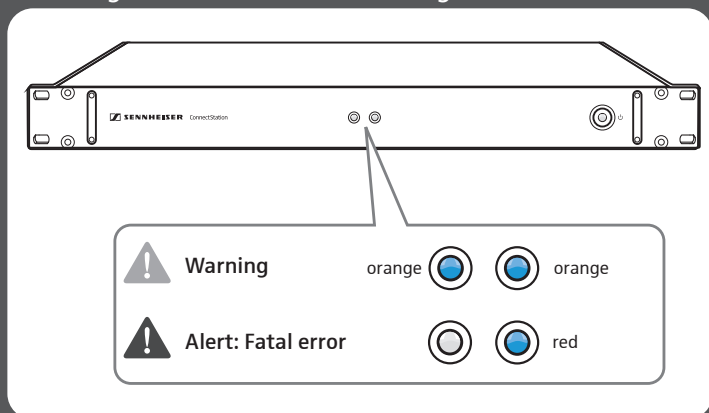

Sennheiser electronic GmbH & Co. KG
Am Labor 1, 30900 Wedemark, Germany
www.sennheiser.com
Printed in Germany, Publ. 06/15, 560069/A02